

# Data Sheet

## Series H9

### Electronic Metering Pumps

*Series H9 electronic metering pumps combine the accuracy of microprocessor control with 1000 psi injection pressure capability. These high-pressure, programmable pumps are ideal for applications requiring precise injection of concentrated boiler feed chemicals (Max. Output to 3.2 GPD, Max. Pressure to 1000 psi).*

**\*\*Minimum System Pressure 200 psi.**

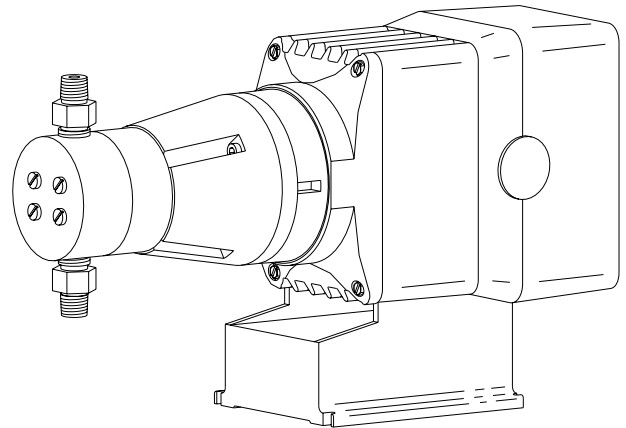

#### Keypad Adjustable Pressure Capacity

An LMI exclusive, the Series H9 features adjustable pressure control that allows for pressure calibration to your system.

#### Unique V-Seal Design

LMI's spring-loaded V-Seals prevent leakage and reduce pump maintenance. This design feature eliminates the need for packing nuts normally used on packed plunger pumps.

#### High-Pressure Module

LMI's precision-engineered, high-pressure module includes a 316 S.S. liquid handling assembly.

The cartridge valves are easily serviced and feature closely-guided 316 S.S. balls and PTFE seats for accurate, repeatable output.

#### Manual Mode Select

The manual stroke rate is adjustable from 1 stroke per hour to 100 strokes per minute, allowing for extreme output flexibility.

#### External Mode Select

Three external control modes are available to choose from:

- **Pulse Divide**  
(÷) incoming pulses  
(reed switch, transistor, opto-coupler, or hall effect sensor)  
From 1 to 999
- **Pulse Multiply (Batch Accumulate)**  
(x) incoming pulses  
(reed switch, transistor, opto-coupler, or hall effect sensor)  
From 1 to 999
- **4 - 20 mA (Slope Adjustable)**  
Programmable 4 - 20 mA or  
0 - 20 mA response direct or inverse

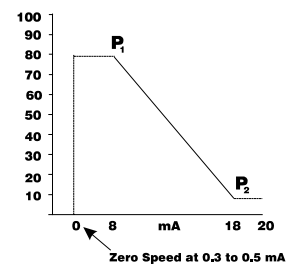
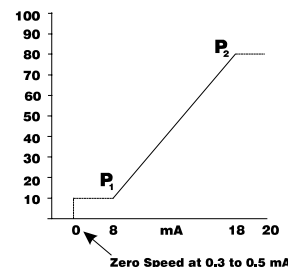

8 Post Office Square  
Acton, MA 01720 USA  
TOLL FREE: (800) 564-1097  
TEL: (978) 263-9800  
FAX: (978) 264-9172  
<http://www.lmipumps.com>



Replaces same of Rev. B 6/01  
1787.C 5/02

---

---

## Corrosion Resistant Nema 4X (IP65)

Corrosion resistant, O-Ring sealed enclosure of glass-fiber reinforced polypropylene protects the pump from harsh chemicals and tough environments.

The electronic controls and circuitry are fully and permanently encapsulated from protection from moisture and corrosive atmospheres.

## Rugged Construction

The Series H9 features a thick-wall, glass-fiber reinforced thermoplastic housing. The integrated plastic and metal structural and magnetic components result in a vibration and shock resistant design not found in competitive products.

Encapsulated ribbon-cable ends provide additional connection strength and corrosion resistance not found in most programmable, electronic-metering pumps.

---

---

## Dimensions

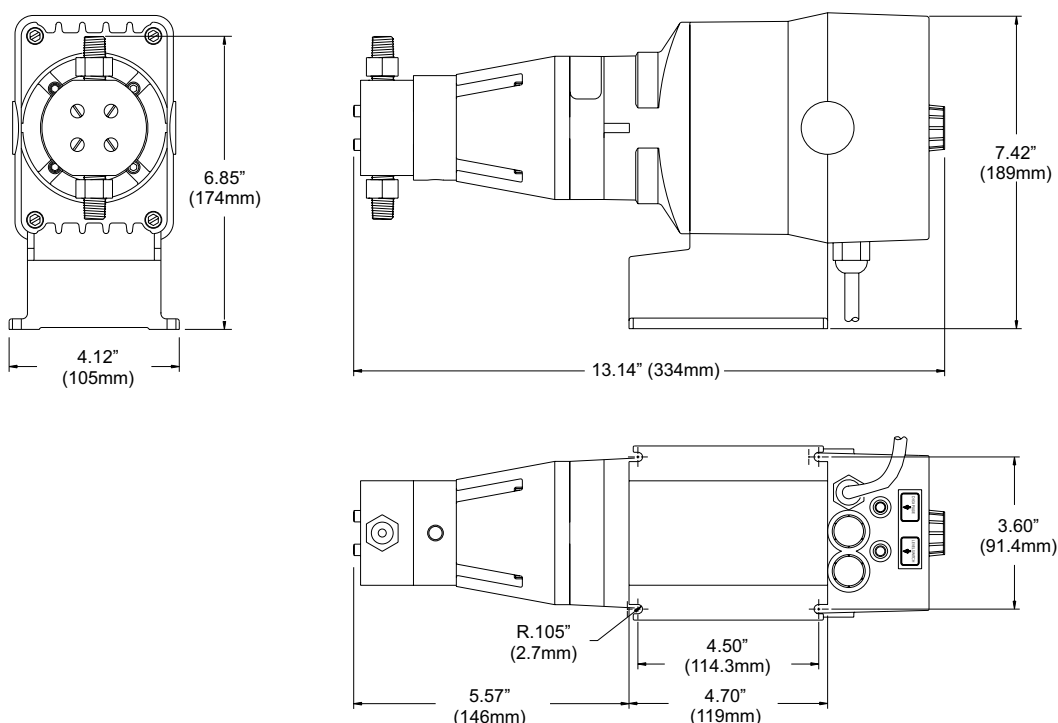

---

---

## Specifications

Model	Maximum Output Capacity	Maximum Injection Pressure	Volume/Stroke (ml) (Min - Max)	Liquid Handling Assembly	Connections
H91 <input type="checkbox"/> -987	0.14 GPH (0.50 l/h)	300 psi (21 Bar)	.030 – .080	316 S.S.	1/4" NPT M
H92 <input type="checkbox"/> -987	0.10 GPH (0.38 l/h)	600 psi (42 Bar)	.015 – .060	316 S.S.	1/4" NPT M
H93 <input type="checkbox"/> -987	0.07 GPH (0.25 l/h)	1000 psi (70 Bar)	.010 – .040	316 S.S.	1/4" NPT M

When ordering, please indicate desired voltage option by inserting one of the following numbers in the box (☐).

1 = 120 VAC AC, USA Only  
2 = 240 VAC AC, USA Only

3 = 220-240 VAC, DIN Plug  
5 = 240-250 VAC, UK Plug

6 = 240-250 VAC, Aust/NZ Plug  
7 = 220 VAC, Swiss Plug