



295 DeKalb Pike, North Wales PA 19454
Tel: 215-699-8700 (888-363-7886)
Fax: 215-699-0370 (800-255-4017)

SERIES BN PORTABLE MIXERS ASSEMBLY INSTRUCTIONS AND PARTS LIST

**ATTENTION: FOR PROPER INSTALLATION AND OPERATION OF YOUR NEPTUNE MIXER,
READ THESE INSTRUCTIONS BEFORE USING.**

Description

Series BN Mixers are designed for economical mixing of small tanks and open head drums. The mixer can be easily mounted and the shaft angle can be easily adjusted for optimum mixing. The mixer can be conveniently moved from one container to another.

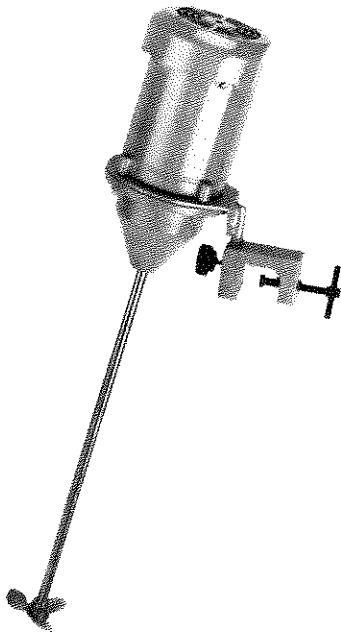

Unpacking

When unpacking the mixer, check carefully for damage that may have occurred during transit. Check for missing parts.

General Safety Information

Warning: These mixers are intended for specific functions. Please follow all instructions for safe and proper use.

- (1) Be certain that all mounting hardware and the coupling and propeller set screws are properly tightened prior to operation.
 - (2) Clamp securely to rim. Be certain propeller is not touching side or bottom of tank.
 - (3) Series BN Mixers are intended for use on open head drums or small tanks 100 gallons or less. Only the most mild of mixing can be accomplished in larger tanks.
 - (4) Perform electrical connections and wiring in accordance with the electrical area requirements and local electrical codes.
 - (5) Do not attempt to adjust mixer when mixer is operating, this could result in personal injury or damage to the tank and mixer.
 - (6) Always wear required safety equipment including eye protection when observing mixer performance or when adding materials to a tank while the mixer is operating.
-

Assembly Instructions

Series BN Mixers

The Series BN Mixer is mostly pre-assembled. Attaching the shaft and propeller to the mixer, mounting the clamp to the tank and placing the mixer in the clamp is all that is required before operation.

Assembly and Mounting:

- (1) Attach clamp (3) to tank using handwheel (14) on clamp.
- (2) Attach propeller to round end of mixer shaft.
- (3) Remove plastic cover (11) for access to couplings.
- (4) Insert end of shaft with flat into coupling and tighten setscrews.
- (5) Recheck all hardware for proper tightening.
- (6) Replace plastic cap.
- (7) Mount mixer to clamp by inserting motor mount assembly rod (2) into clamp body (3).
- (8) Position mixer and tighten knob (5).

Adjusting the Mixer:

- (1) Mixer may be rotated left to right by loosening knob (5) and pivoting the unit. Re-tighten knob (5).
- (2) The mixer, as received, provides a shaft angle which should be adequate for most applications with this mixer.
- (3) The angle of the shaft can be adjusted. Loosen clamp knob (4) and turn the setscrews toward the tank wall to achieve a greater shaft angle. Do not exceed 15°.

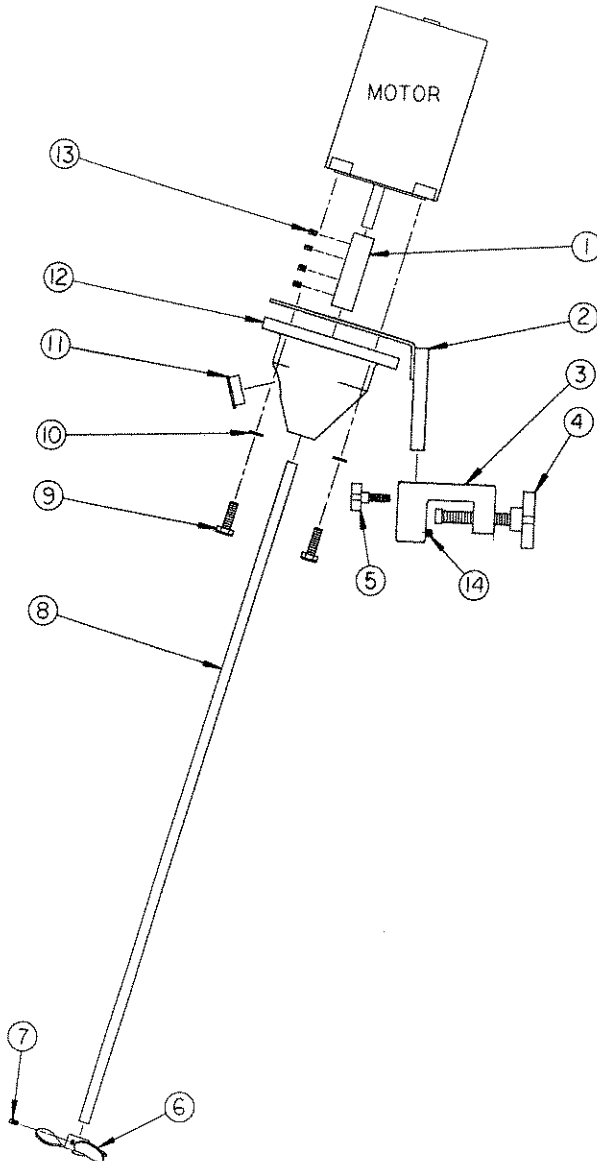

"BN" SERIES MIXER

ITEM NO.	PART NO.	QTY.	DESCRIPTION
1	002518	1	Shaft Coupling 1/2" x 1/2"
	002520	1	Shaft Coupling 5/8" x 5/8"
	002523	1	Shaft Coupling 5/8" x 1/2"
2	003245	1	Motor Mount Assembly
3	003242	1	Clamp Body
4	106672	1	Clamp Screw
5	106652	1	Pivot Knob
6	000514	1	Propeller 1/2" - 316SS
	000539	1	Propeller 5/8" - 316SS
7	100406	1	Setscrew 1/4-20 x 5/16" lg. - 316SS (Supplied with Propeller)
8	000507	1	Propeller Shaft 1/2" Dia. x 32" lg. - 316SS
	000563	1	Propeller Shaft 5/8" Dia. x 32" lg. - 316SS
9	101238	4	Hex Head Screw 3/8-16 x 1-1/4" lg.
10	100217	4	3/8" Lock Washer
11	102931	1	Plug
12	106670	1	Mixer Nose - Coupling Guard
13	106183	4	Setscrew 1/4-20 x 3/16" lg.
14	106698	2	Setscrew 5/16-18 x 1-1/4" lg.